



SVENSKA SKIDFÖRBUNDET
SWEDISH SKI ASSOCIATION



Bruksvallsloppet

18-20 november 2016

Team Captain's meeting
BRUKSVALLSLOPPET

BRUKSVALLARNA 2016-11-19

Huvudsponsor





SVENSKA SKIDFÖRBUNDET
SWEDISH SKI ASSOCIATION



Agenda

Introduction of the OC, the Jury and SSA
Event Program
Timetable
Weather Forecast
Entries and draw
Stadium
Courses
Ski testing and warming up
Course Preparation and Grooming
Information from the TD
Information from SSA/FIS
Information from the OC

Huvudsponsor



Lokala sponsorer (ta bort om ni ej har det)



SVENSKA SKIDFÖRBUNDET
SWEDISH SKI ASSOCIATION



Introduction of the OC, the Jury and SSA

OC:

Chief of competition:	Mikaela Sundbaum
Chief of comp. A:	Magnus Myhr
Competition Secretary:	Christina Persson
Chief of Course:	Tobias Jönsson
Chief of stadium:	Ingar Mikkelsen
Chief of timekeeping:	Staffan Lidén

JURY:

TD:	Erik Björelind
TD Assistant:	Pär Dudal
TD A national	Magnus Elmkvist
Chief of competition:	Mikaela Sundbaum

Huvudsponsor



SVENSKA SKIDFÖRBUNDET
SWEDISH SKI ASSOCIATION



Event Program

Friday 18/11, free technique.

6km - D21/Senior Ladies.

10km - H21/ Senior Men.

Saturday 19/11, classic technique.

10km - H17-20 / Junior Men

15km - H21 / Senior Men

10km - D21 / Senior Ladies

5km - D17-20 / Junior Ladies

Sunday 20/11, classic technique.

Sprint

H17-20 / Junior Men

D17-20 / Junior Ladies

D21 / Senior Ladies

H21 / Senior Men

Huvudsponsor





SVENSKA SKIDFÖRBUNDET
SWEDISH SKI ASSOCIATION

Timetable sunday



07.00 - 16.00	Race office open at Hotell Bruksvallsliden
08.00 – 08.55	Course open for warm up
09.00 ~ 11.00	Prologue - Junior Men, Junior Ladies, Senior Ladies, Senior Men
11.15	TCM Seniors Bibs
11.00 – 11.35	Sprintcourse open for warmup, only for qualified seniors.
11.40 ~ 13.30	Quarterfinals, semifinals and finals senior Ladies and Men - Broadcasting
~ 13.40	Prize giving ceremony
13.35 – 13.45	Sprintcourse open for warmup, only for qualified junior.
13.50 ~ 15.20	Quarterfinals, semifinals and finals Junior Ladies and Men
~ 15.30	Prize ceremony direct after the race at finish
15.30 –	Course open for training and cool down

Huvudsponsor



SVENSKA SKIDFÖRBUNDET
SWEDISH SKI ASSOCIATION



Weather forecast

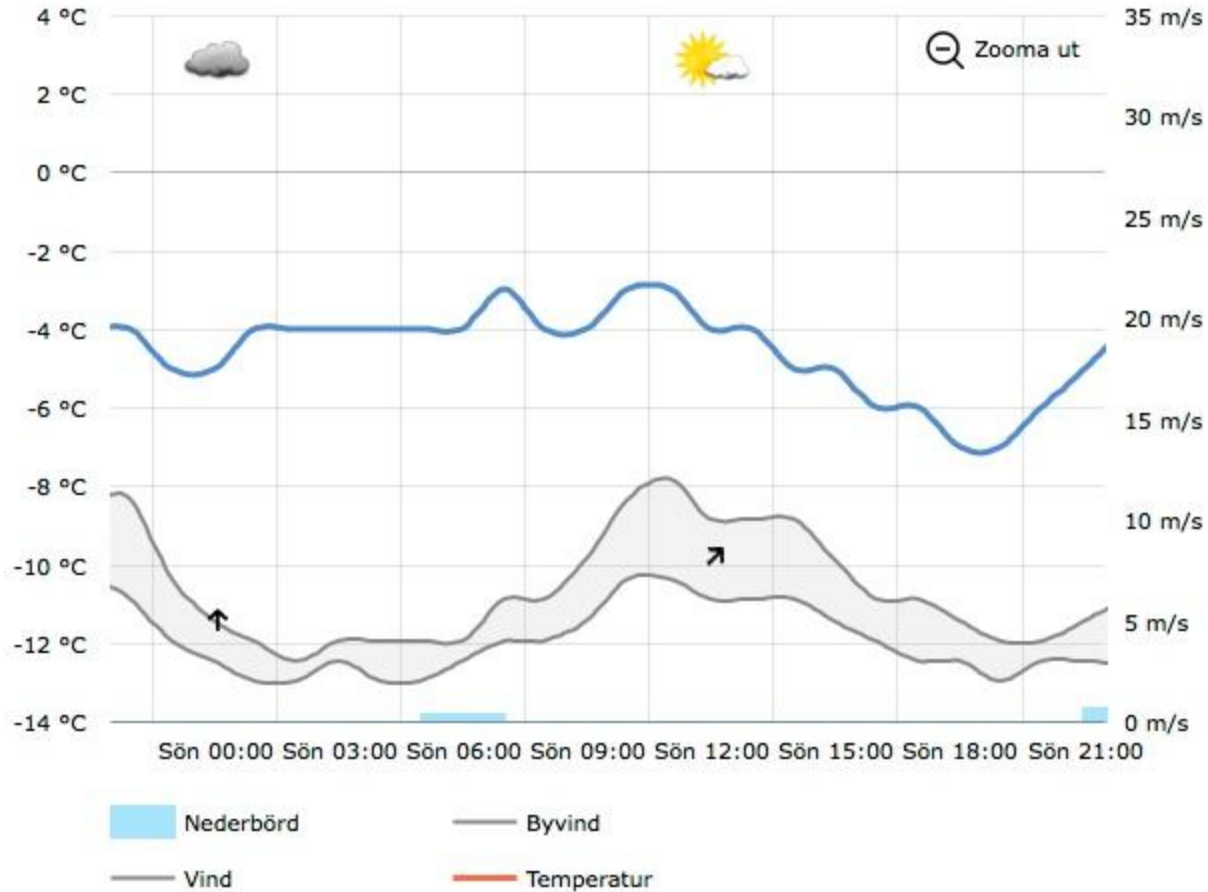

Huvudsponsor





SVENSKA SKIDFÖRBUNDET
SWEDISH SKI ASSOCIATION



Starting order

Prologue

Startlist is created using FIS-points. Lowest points starts first.

The ones without FIS-points are placed at the end of startlist.

Schedule Sprint

Timing on Heats

Lucky loser according to updated ICR

No B-finals

Huvudsponsor





SVENSKA SKIDFÖRBUNDET
SWEDISH SKI ASSOCIATION



Startlist and bibs

Startlists available on website

www.bruksvallsloppet.se

and at Race office from tomorrow.

**Bibs will be received at the race office from 07.00
sunday morning.**

**Note! Bibs for qualified senior at TCM on
stadium 11.15**

Bibs for qualified juniors at Race Office

Huvudsponsor





SVENSKA SKIDFÖRBUNDET
SWEDISH SKI ASSOCIATION



Stadium



Huvudsponsor





SVENSKA SKIDFÖRBUNDET
SWEDISH SKI ASSOCIATION



Stadium layout

Prologue

1 transponder

Finals

SWE senior skiers: 1 personal transp. + 1 at start

INT senior skiers: 1 with bib + 1 at start

Juniors only 1 chip

Prologue - Start gate - 15 sec start interval

Starting procedure finals

4 lanes to finish

Huvudsponsor





SVENSKA SKIDFÖRBUNDET
SWEDISH SKI ASSOCIATION



Courses

Seniors Men H21 - course length 1450m

Senior Ladies D21 - course length 1350m

Juniors Men & Ladies - course length 1350m

Pole service

Huvudsponsor





SVENSKA SKIDFÖRBUNDET
SWEDISH SKI ASSOCIATION



Courses

Pole service

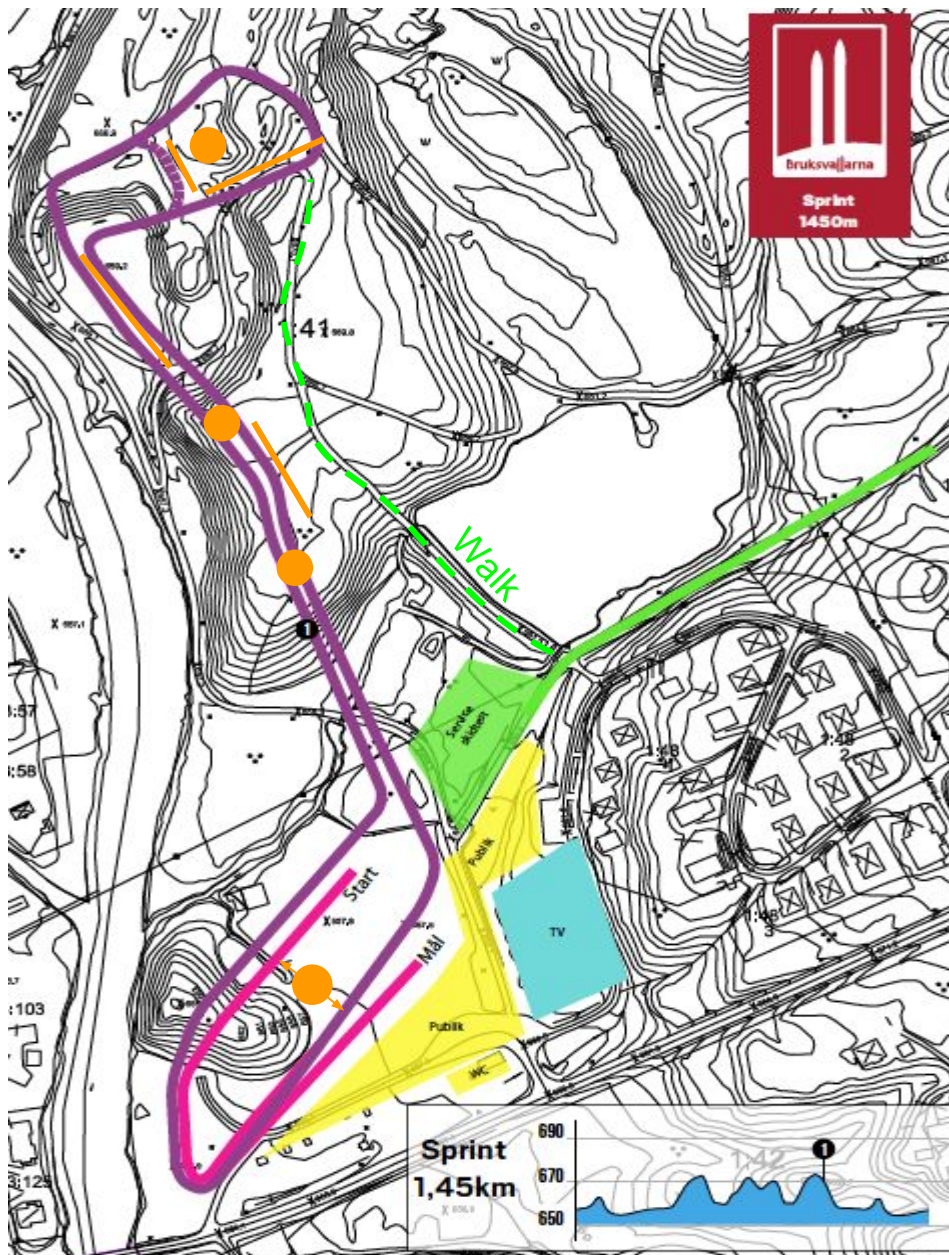

Huvudsponsor





SVENSKA SKIDFÖRBUNDET
SWEDISH SKI ASSOCIATION



Ski testing and warming up

Skitesting and warmup allowed at
competition course until 08.55

Only testing and warm up in competition
direction.

During competition use Warm Up Course.

Huvudsponsor





SVENSKA SKIDFÖRBUNDET
SWEDISH SKI ASSOCIATION



Course Preparation and Grooming

Artificial snow in the bottom blended with natural snow on top on the track

4 tracks

Grooming starts 22.00
with Pisten Bully

Huvudsponsor





SVENSKA SKIDFÖRBUNDET
SWEDISH SKI ASSOCIATION



General information from the TD

Congratulations to today's winners

Thanks for good race and behavior on course

Ski in the right direction

Please respect instructions from all officials

Overtaking rule also for classic with two tracks, incident today

Be in time for start - random pole length test

Start procedures

Huvudsponsor





SVENSKA SKIDFÖRBUNDET
SWEDISH SKI ASSOCIATION

ICR 325.4.9 Start procedure

Any competitor who causes a false start will be sanctioned by a written reprimand. Following the first false start in a heat, any competitor who causes a subsequent false start in the same heat will be required to withdraw from the competition. The competitor will be ranked as the last position of the applicable final, semifinals or quarter finals heat (rank 6, 12, 30).

Huvudsponsor





SVENSKA SKIDFÖRBUNDET
SWEDISH SKI ASSOCIATION

- 315.5.3 Competitors are organised on the pre-start line where instructions are given and start lanes designated. The starter will give the command “**take your start positions**” and the competitors advance to the start line. When all competitors are at the start line, the starter will give the command “**Set**” and all the competitors must remain motionless until the starter gives the **start signal**.
- 315.5.4 Starts that do not use gates follow the same principles and procedures as stated above.
- 315.5.5 Competitors are not allowed to change tracks within marked corridors the first 10-15 m after the start line.

Huvudsponsor



SVENSKA SKIDFÖRBUNDET
SWEDISH SKI ASSOCIATION



Thank you and good luck!

Huvudsponsor

